

How to use a Slide Buckle Set

What is a Slide Buckle?

It is an adjustable, unisex style buckle, designed to be used with 1-inch wide webbing, belting or elastic. So quick and easy to use, you'll have a new belt in minutes! Buy additional belt tips and make more belt straps to exchange with the buckle. A new color every day!

Item #724

What are the parts?

Each set includes...

1 Slide Buckle and 2 Belt Tips

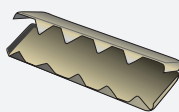
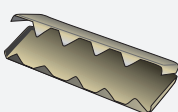

Belt Tips

Buckle

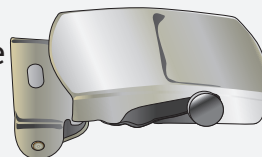

How do you use a Slide Buckle?

1. **Making the belt:** Cut belting to waist measurement plus 14".

2. Use scissors to trim one end so it is slightly rounded. Seal raw edge with Fray Check®. Insert one end of belting into belt tip, making sure edges are even and end is fully inserted into tip. Use pliers to flatten the middle and sides of tip together. Teeth should extend into belting. Check to be sure belting is secure.

2.

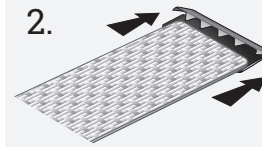

TIP: Place a scrap of fabric over the tip when using pliers to avoid scratching the metal.

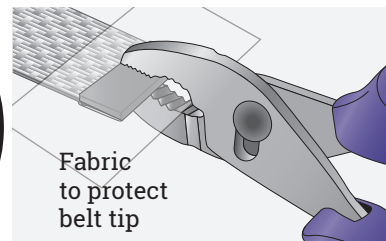

Fabric to protect belt tip

3. **Attaching the buckle:** Slide belt tip under clamp at end of buckle; press clamp down to secure belting.

3.

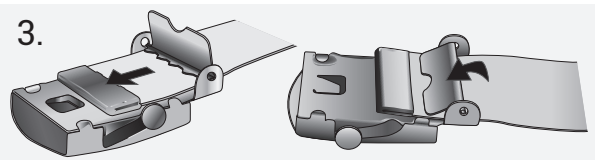

4. **Fit and finish the belt:** Place belt around waist and slide opposite end of belting into buckle to check the fit. Slide lock to secure belting. Trim any excess belting.

4.

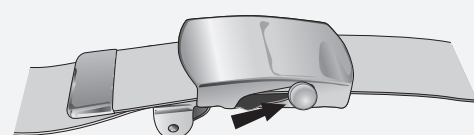

5. Follow step 2 to apply second tip to end of belt strap.

